

Connection with Stranded Cable



See below:  
[Approvals and Compliances](#)

**Description**

- Flexible wire :
- Push-mounted rear-side
- 1 Function Connection with stranded Cable
- Quick connect terminals 4.8 x 0.8 mm
- Approved together with power entry module

**References**

Fits to type: [CE](#); [CG](#); [CG-Bowdencable](#); [KE](#); [KG](#); [KG-Bowdencable](#)

**Weblinks**

[pdf data sheet](#), [html datasheet](#), [General Product Information](#), [Approvals](#), [Distributor-Stock-Check](#), [Accessories](#), [Detailed request for product](#)



**Approvals and Compliances**

Detailed information on product approvals, code requirements, usage instructions and detailed test conditions can be looked up in [Details about Approvals](#)

SCHURTER products are designed for use in industrial environments. They have approvals from independent testing bodies according to national and international standards. Products with specific characteristics and requirements such as required in the automotive sector according to IATF 16949, medical technology according to ISO 13485 or in the aerospace industry can be offered exclusively with customer-specific, individual agreements by SCHURTER.



**Application standards**

Application standards where the product can be used

| Organization  | Design                         | Standard       | Description  |
|---|--------------------------------|----------------|--|
|  | Suitable for applications acc. | IEC/UL 62368-1 | Audio/video, information and communication technology equipment - Part 1: Safety requirements          |
|  | Suitable for applications acc. | IEC 60601-1    | Medical electrical equipment - Part 1: General requirements for basic safety and essential performance |

**Compliances**

The product complies with following Guide Lines

| Identification  | Details                           | Initiator   | Description   |
|---|-----------------------------------|-------------|---|
|  | <a href="#">RoHS</a>              | SCHURTER AG | Directive RoHS 2011/65/EU, Amendment (EU) 2015/863  |
|  | <a href="#">REACH</a>             | SCHURTER AG | On 1 June 2007, Regulation (EC) No 1907/2006 on the Registration, Evaluation, Authorization and Restriction of Chemicals 1 (abbreviated as "REACH") entered into force. |
|  | <a href="#">Medical Equipment</a> | SCHURTER AG | Suitable for use in medical equipment according to IEC/UL 60601-1 (1 MOOP, 1 MOPP)  |

## Dimension [mm]

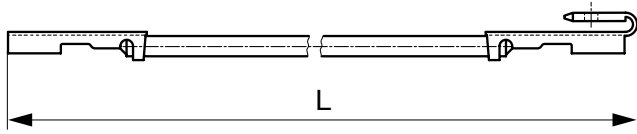

Type A, (Lenght see order table)

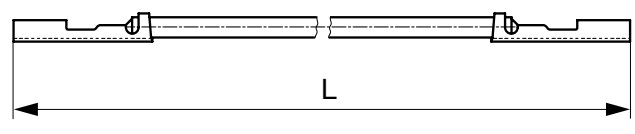

Type B (Length see order table)

## All Variants

| Type   | L [mm] | System 1<br>Anzahl | System 2<br>Anzahl | System 3<br>Anzahl | System 4<br>Anzahl | Order Number |
|--------|--------|--------------------|--------------------|--------------------|--------------------|--------------|
| Type A | 70 mm  | 1                  | 1                  | 1                  | -                  | 0881.0074    |
| Type A | 100 mm | 1                  | 1                  | 1                  | -                  | 0881.0075    |
| Type B | 70 mm  | 1                  | -                  | -                  | 1                  | 0881.0076    |
| Type B | 100 mm | -                  | -                  | -                  | 1                  | 0881.0077    |

Most Popular:

Availability for all products can be searched real-time: <https://www.schurter.com/en/info-center/support-tools/stock-check-distributors>

For 2-pole versions 2 x 0881.0074 is needed in system no. 2 and 3 resp. 2 x 0881.0076 in system no. 4

**Packaging unit** 100 Pcs